

THE BRITISH MASS SPECTROMETRY SOCIETY

# The 41<sup>st</sup> BMSS ANNUAL MEETING

08-10 SEPTEMBER 2020

*In partnership with*

Sheffield  
Hallam  
University

EXHIBITOR GUIDE

**BMSS**

SHEFFIELD 2020

Sheffield Hallam University (SHU) is a most appropriate venue for the society's 41st Annual Meeting - anchored by the research groups' of Professor Malcolm Clench and Professor Simona Francese. SHU provides state-of-the-art lecture theatres and recently refurbished exhibition and social spaces. The SHU City Campus is at the heart of an energized and accessible city with many affordable hotel options.

A vibrant national mass spectrometry society is in everyone's interest, ...academia, industry & vendors alike, so I warmly invite you to join us for BMSS41 in Sheffield.

**BMSS** ...*the world's first mass spectrometry society* !

*Ashley Sage*

**BMSS Chair**



**BMSS41**



# ...Location, Location, Location

## Sheffield

Sheffield is the natural location for the 41st BMSS Annual Meeting. Located close to the geographic center of the UK it provides an easily accessible and affordable venue - anchored by the research groups' of Professor Malcolm Clench and Professor Simona Francese.

## Mass Spectrometry

The universities of the region and their associated institutes and hospitals form a network of MS excellence. Most of the major instrument companies have facilities in the region together with numerous MS service providers.

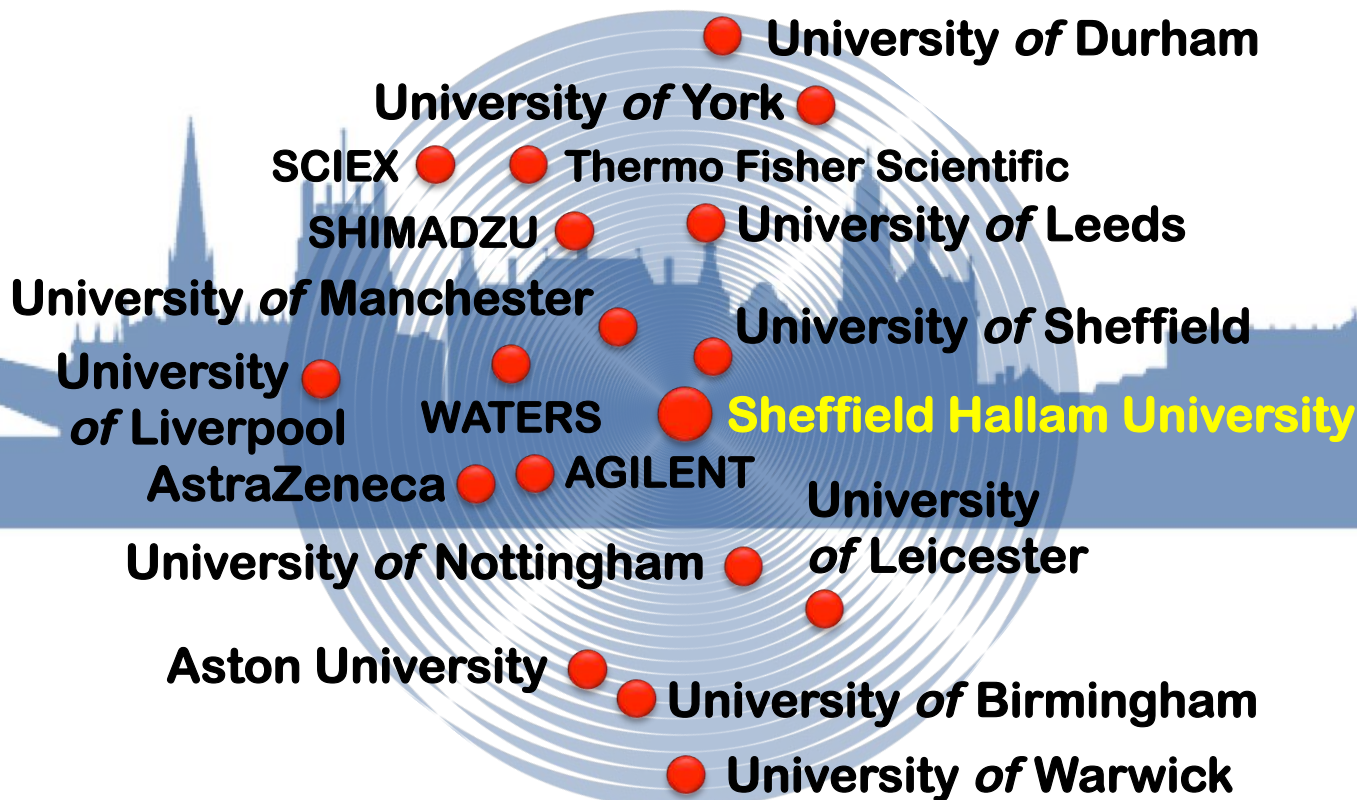

SHEFFIELD 2020

# BMSS41 Annual Meeting...

## The Conference Venue

The SHU City Campus, just two minutes walk from Sheffield station, offers convenient and modern facilities in the heart of the city. The Pennine & Peak lecture theatres and the Hallam Mezzanine-Concourse have been recently refurbished and will provide the scientific and social hub of BMSS41.

Hallam Hall, Hallam Central and Hallam View, all interconnected by the Mezzanine-Concourse (Owen Building level 6), will house the BMSS41 exhibition, scientific poster sessions and catering services. The BMSS Social Evening will also be held in the in the same location.



## The Social Evening

The BMSS Annual meeting has evolved, in response to members' wishes, to incorporate an inclusive social event on the opening night of the conference (8th September 2020). BMSS41 will feature a selection of local beers and a traditional Yorkshire Pie & Pea Supper with an optional dash of Henderson's Relish, Sheffield's unique contribution to the culinary canon. Delegates are advised not to allow the phrase '*Worcester Sauce*' to pass their lips whilst within Sheffield's City limits as this may provoke an impolite 'invitation to withdraw' from the assembled company!



**Sheffield  
Hallam  
University**

# BMSS41

# ...and Social Program

## The Conference Dinner

The BMSS41 Conference Dinner will be held in Sheffield's spectacular Cutlers' Hall, on Wednesday 9<sup>th</sup> September, just a five minute walk from the SHU City Campus. Cutlers' Hall preserves and celebrates Sheffield's rich history in the artisanal and industrial production of silverware that for centuries has graced the finest tables in the world.

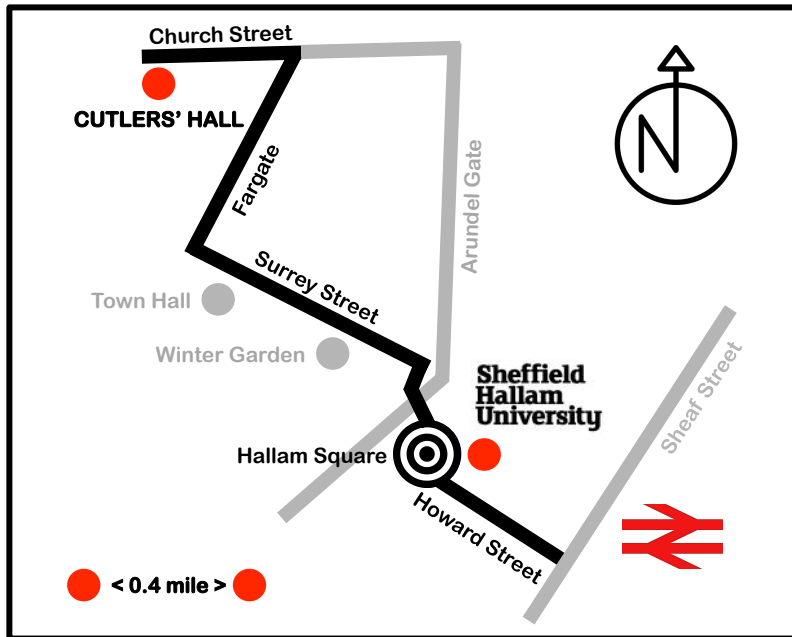

# SHEFFIELD 2020



# BMSS41 Sponsorship Options...

## Thank You !

The BMSS Annual Meeting would not be possible without the very generous support of ALL of our exhibitors and sponsors.



**Sheffield**

## Sponsorship Options

The standard sponsorship options are listed below:

- Barber Lecture Prize (judged best oral): £350
- Bordoli Poster Prize (judged best poster): £350
- Delegates Choice Poster Prize: £350
- Conference Mixer (SHU) Tuesday 08-SEP-20: £1,475
- Pie & Pea Supper/Social Evening (SHU) Tuesday 08-SEP-20: from £2,000
- Pre-Dinner Reception (Cutlers' Hall) Wednesday 09-SEP-20: £1,250
- Conference Dinner (Cutlers' Hall) Wednesday 09-SEP-20: £2,000
- BMSS41 Registration Badge Branding & Messaging: £1,750

## Alternate Options

The BMSS welcomes suggestions for alternate sponsorship arrangements.

If you have an original sponsorship proposition we would like to discuss that with you... Please contact the BMSS Meetings Secretary to develop your idea: [mark\\_mcdowall@icloud.com](mailto:mark_mcdowall@icloud.com)



**BMSS41**

# ...and Exhibitor Information

## The Exhibition Plan

The BMSS41 exhibition is set within Hallam Hall, Hallam Central & Hallam View all interconnected by the Hallam Mezzanine. The exhibition, catering points and scientific poster sessions have been integrated to maximise delegate circulation at BMSS41. The BMSS Social Evening (Pie & Pea Supper) will also be located within the exhibition on the evening of Tuesday 8th September 2020.

## Exhibition Plots

- Standard 'bare' plot: 3x2 m (6 m<sup>2</sup>).
- 2x 13 Amp power sockets included.
- 1x table, 1x tablecloth & 2x chairs included per plot (on request).
- Standard plots may be combined.

## Exhibitor Registration

Each Exhibition Plot (6 m<sup>2</sup>) includes three (3) full conference registration badges. Exhibitor passes (*i.e.* exhibition only badges) will not be available in 2020.

## Exhibition Prices

- |                                     |        |
|-------------------------------------|--------|
| • Single plot (6 m <sup>2</sup> )   | £1,000 |
| • Double plot (12 m <sup>2</sup> )  | £2,000 |
| • Triple plot (18 m <sup>2</sup> )  | £3,000 |
| • Premium plot (22 m <sup>2</sup> ) | £ POA  |



## Exhibitors

1 (Premium Plot):

2:  
3:  
4:  
5:  
6:  
7:  
8:  
9:  
10:  
11:  
12:  
13:  
14:  
15:  
16:  
17:  
18:  
19:  
20:  
21:  
22:  
23:  
24:  
25:  
26:  
27:  
28:  
29:  
30:  
31:  
32:  
33:  
34:  
35:  
36:

S H E F F I E L D 2 0 2 0

# BMSS41 Exhibition Floor Plan...

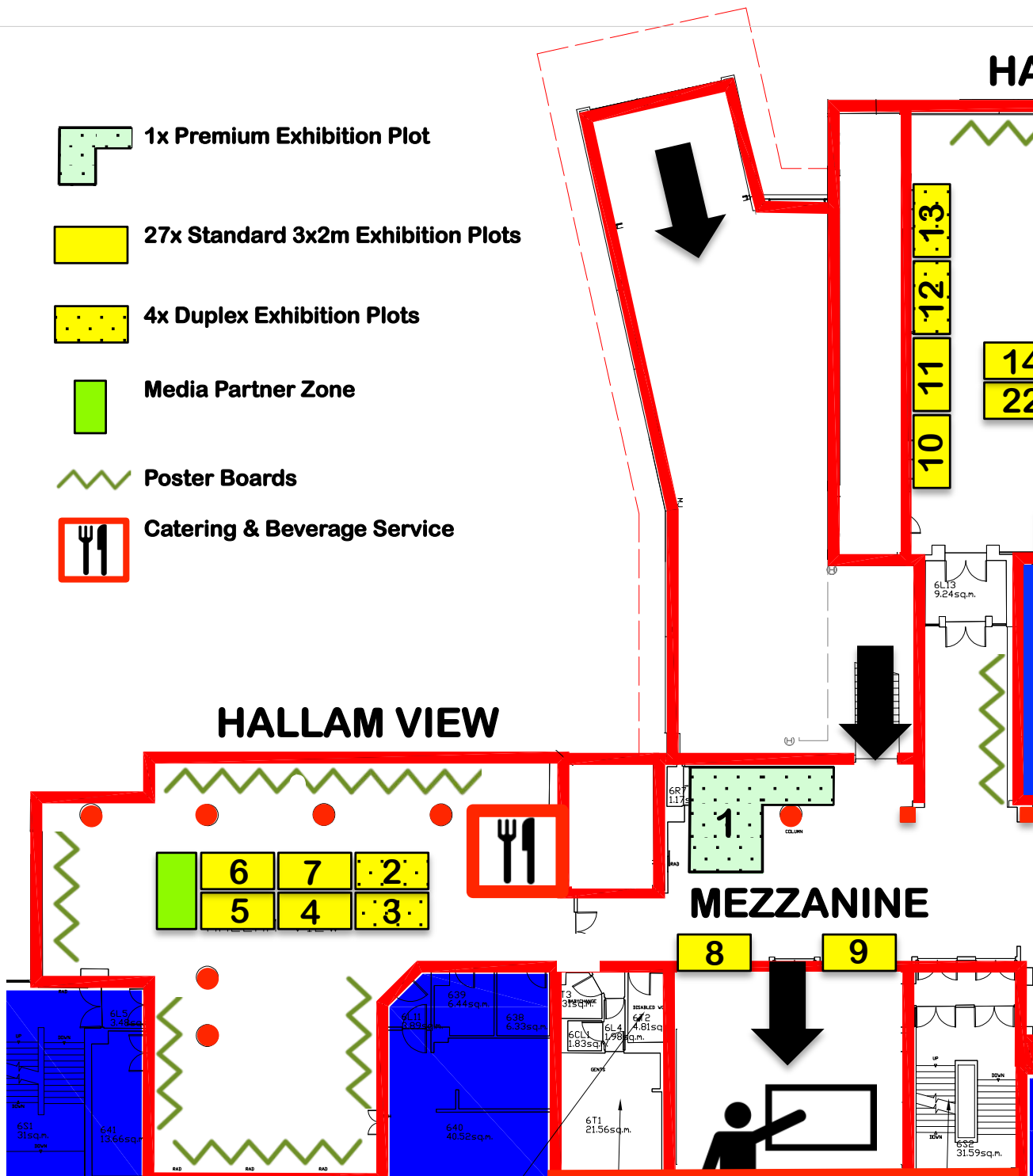

BMSS41



# ...SHU Owen Building Level 6

## HALLAM HALL

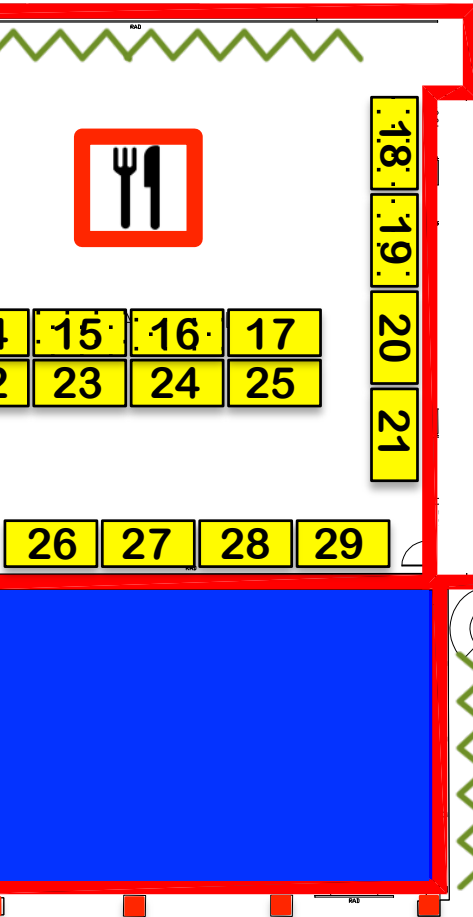

### Height Restrictions:

Hallam Hall: 4.8m

Hallam View: 2.3m

Hallam Central: 3.3m

Mezzanine: 2.1m (Plot #1), and 2.9m (Plots # 8&9)

### Vehicular Access Restrictions:

The SHU Owen Building has a dedicated loading bay with direct road access. Deliveries may be made in person or with the assistance of a third party courier/expediter. Exhibitors who intend to make delivery in person are advised that on-site parking is **NOT** available.

### Lift Restrictions:

The SHU Owen Building loading bay has direct lift access to L6 – lift floor dimensions: 2.2m x 1.4m & weight restriction: 1,500kg.

### Pallet Truck Availability:

SHU have one (1) manual fork lift/pallet truck available to assist BMSS41 exhibitors to bringing their own boxes/crates, from the roadside loading bay, to their respective exhibition plot.

## HALLAM CENTRAL

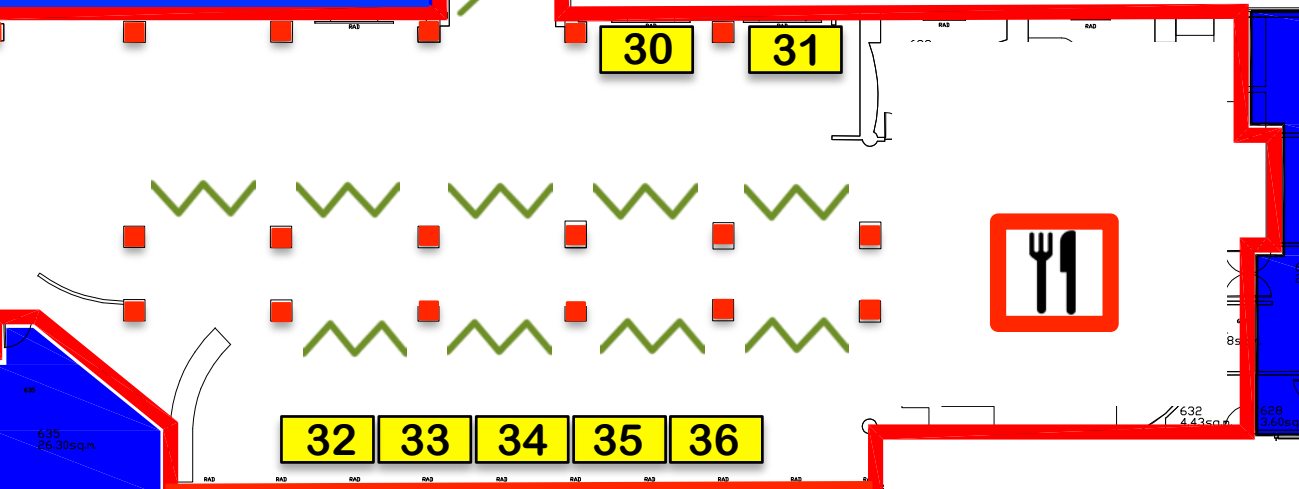

# SHEFFIELD 2020

# BMSS41 Annual Meeting...

## Scientific Program (08-10 September):

- Lectures
- Posters
- Welcome Mixer
- Pie & Pea Supper/Social Evening
- Conference Dinner
- Vendor Exhibition
- The BMSS AGM

## Introduction To Mass Spectrometry Course (07-08 September):

- Lectures
- Workshops
- Course Notes

## Careers Workshop (08 September):

- Careers in MS Workshop
- Expert Advice

## Exhibitor Enquiries:

To reserve exhibition space or negotiate sponsorship options please contact the BMSS Meetings Secretary:

**+44 (0) 161 998 7757**  
**mark\_mcdowall@icloud.com**

## General Enquiries:

For general event information please contact the BMSS Administrator:

**+44 (0) 1606 810562**  
**admin@bmss.org.uk**

**www ● bmss ● org ● uk**



**Sheffield**

**S H E F F I E L D 2 0 2 0**